

- HOSEBED CAPACITIES
- ① 350' OF 2.50" D.J. POLY HOSE
 - ② 550' OF 3.00" D.J. POLY HOSE
 - ③ 1300' OF 4.00" D.H. POLY HOSE
 - ④ 200' OF 1.75" D.J. POLY HOSE

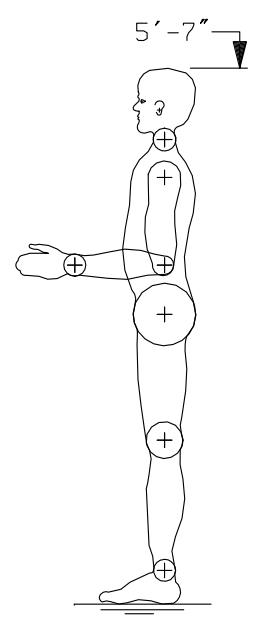
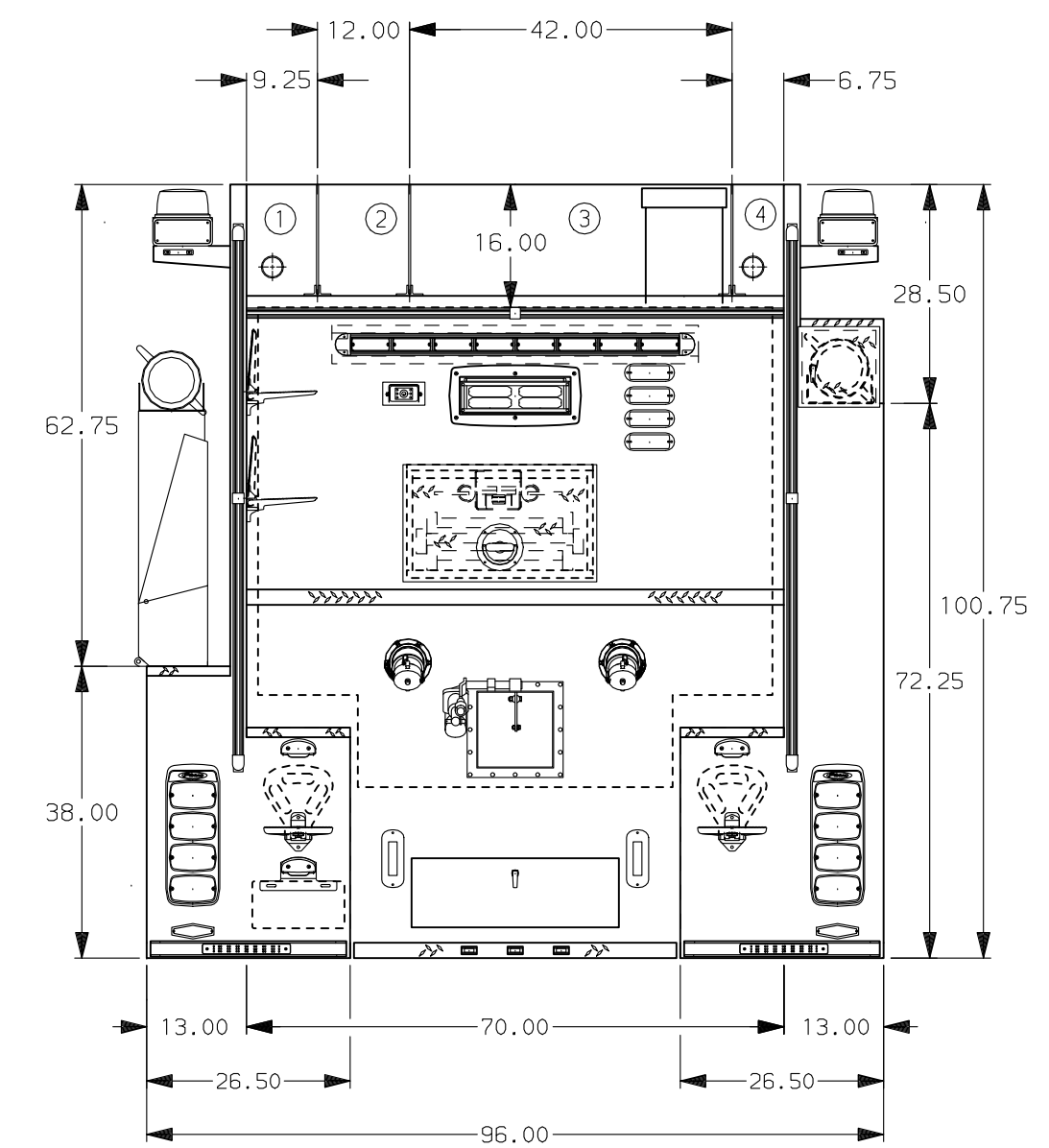
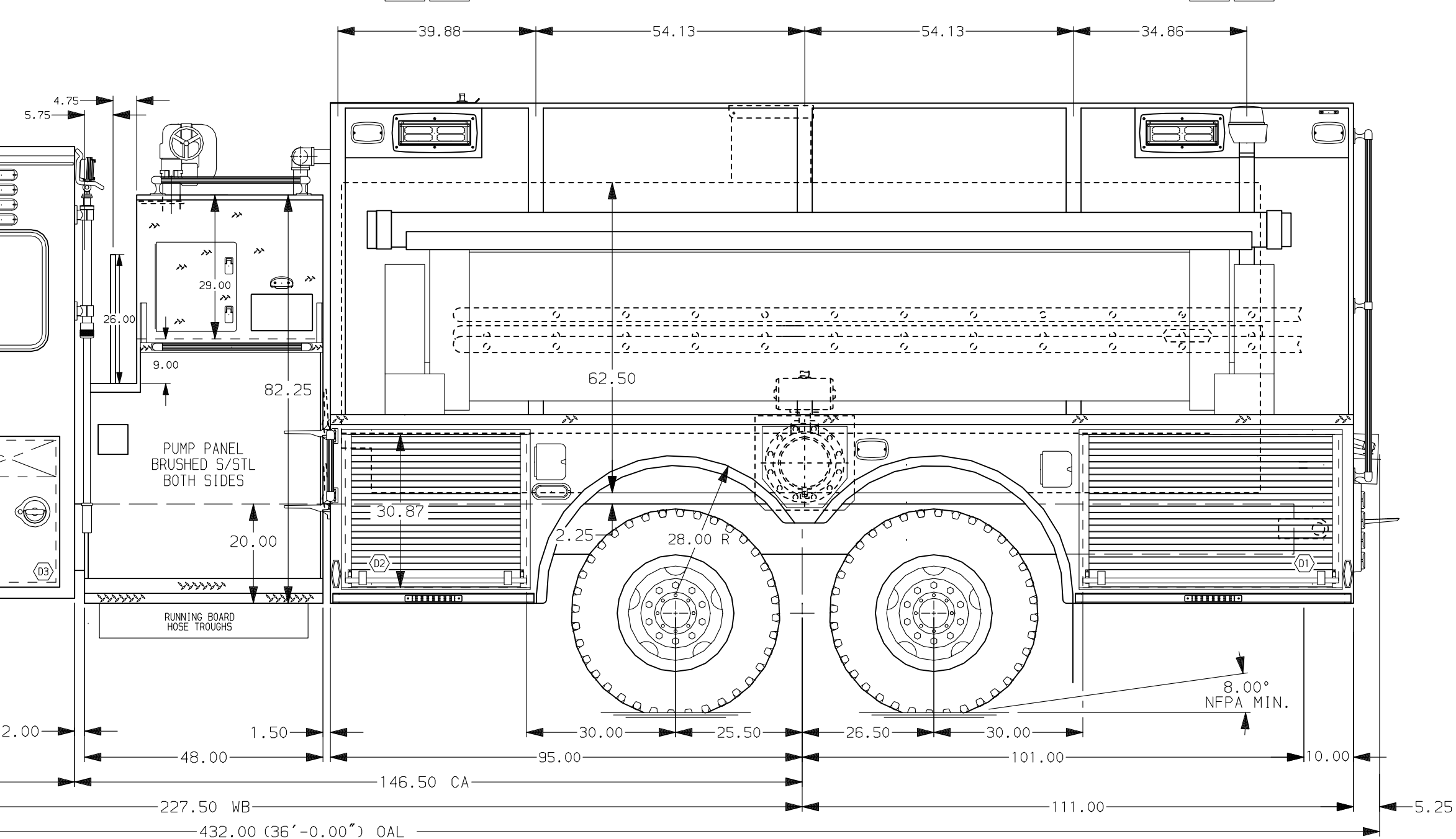
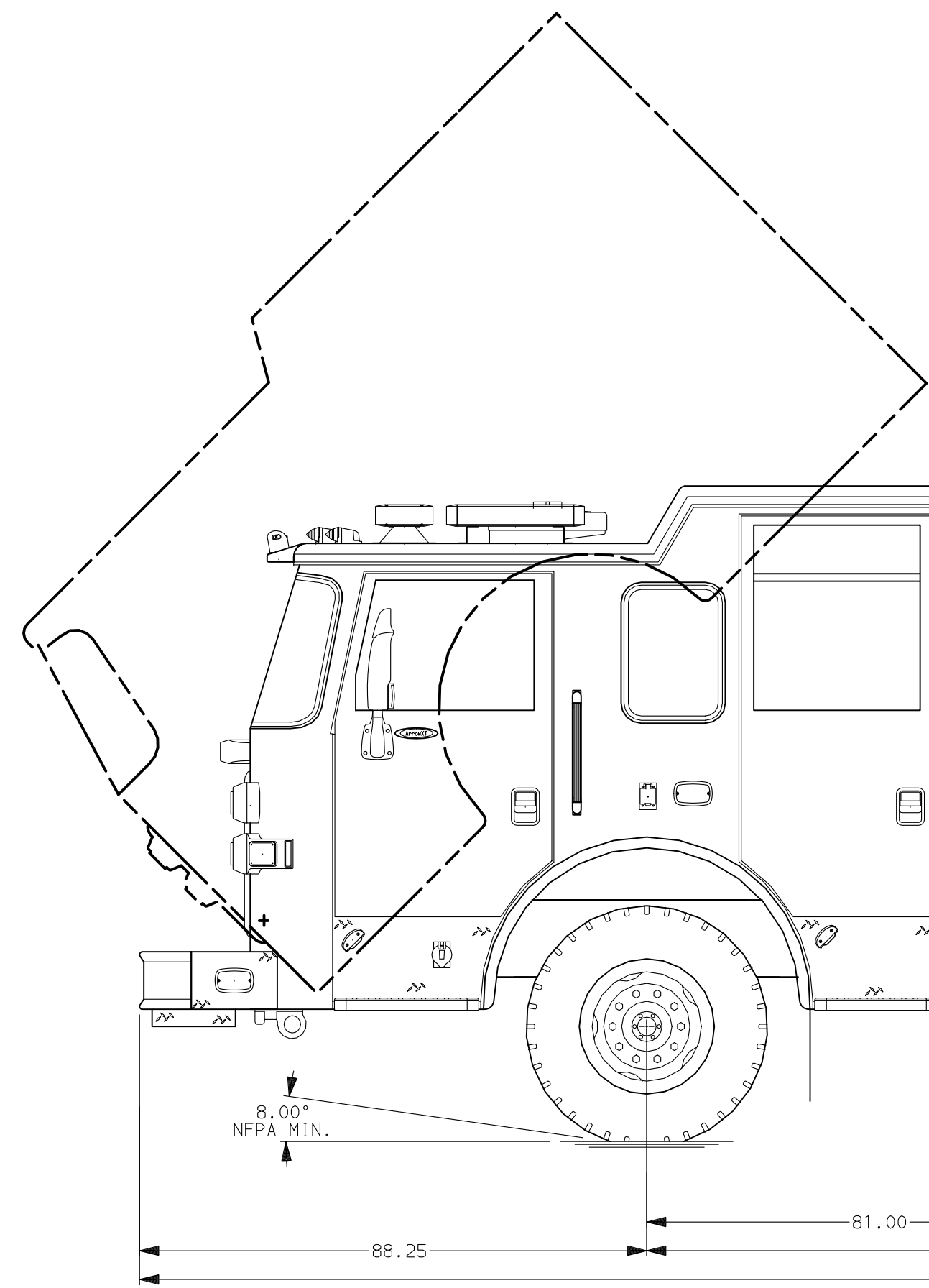

ALUMINUM BODY

MAXIMUM O.A.L. 432.00"

MAXIMUM O.A.H. 130.00"

NOTE
DIMENSIONS SHOWN ARE APPROXIMATE
AND ARE SUBJECT TO MINOR DEVIATIONS
AS MAY OCCUR OR BE NECESSARY IN
CONSTRUCTION.
MINOR DETAILS NOT SHOWN.

CUSTOMER APPROVAL

APPROVED BY: _____
DATE: _____



JOB NO. PRELIM

SCALE 1:24 DATE

DRAWN BY MBO 28APR11

CHECKED BY MNE 29APR11

SHEET SIZE D SHEET NO. 1 OF 1

CHASSIS DATA	TITLE	1500-D-2500P, 206" TANKER BODY, LADDER THRU TANK
MAKE	FOR	(2) X-LAYS, 10" SIDE DUMPS, 3000 GAL FOL-DA-TANK
PIERCE		CAPE ST. CLAIRE VOLUNTEER FIRE COMPANY BID# 252
MODEL		ATLANTIC EMERGENCY SOLUTIONS INC. BRIAN BASHISTA
REV	DATE	BY CH
		AXT8110
DWG NO.	03-7432	